

Battery Insertion

Inserción de las pilas

Energizer

Mfd. for:
Energizer Holdings, Inc.
St. Louis, MO 63141

Light made in China:
Patents Pending



© 2007
Energizer
LPH-121373

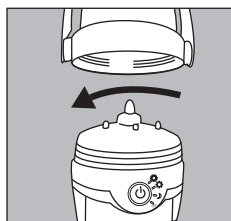

1. Unscrew lens from base of lantern.

Desatornillar los lentes de la base de la linterna.

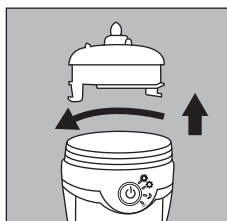

2. Rotate top of base counterclockwise and remove.

Rotar la cubierta de la base en el sentido contrario a las manecillas del reloj y retirar.

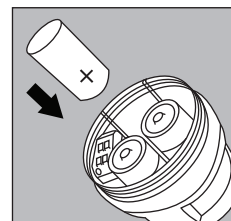

3. Insert 3 D batteries as indicated. Lock top onto base. Screw lens back onto bottom.

Insertar las pilas 3 D según lo indicado. Trabrar la cubierta en la base. Atornillar nuevamente las lentes en el fondo.



2 LED Flashlight



4 LED Flashlight



100 Hour LED Area Lantern



500 Hour LED Area Light



Dual Power Lantern



Floating Lantern



Folding LED Lantern



75 Hour Flashlight



Rechargeable LED Light



Spot/Area Light



3 in 1 LED Flashlight



LED Crank Light

PLAN. PREPARE. PROTECT.®