

6"

2"

BATTERY INSERTION INSERCIÓN DE LAS PILAS INSERTION DES PILES

BATTERY WARNING: Do not install backwards, charge, put in fire or mix with other battery types - may explode or leak causing injury. Replace all batteries at the same time.

ADVERTENCIA DE PILA: Las pilas no deben instalarse al revés, cargarse, echarse en el fuego ni mezclarse con otros tipos de pila. Pueden explotar o tener una fuga, ocasionando una lesión. Reemplace todas las pilas al mismo tiempo.

AVERTISSEMENT CONCERNANT LES PILES : N'installez pas les piles à l'envers, ne les rechargez pas, ne les jetez pas au feu et ne les mélangez pas avec d'autres types de piles. Elle peuvent exploser ou fuir entraînant des blessures corporelles. Remplacez toutes les piles en même temps.

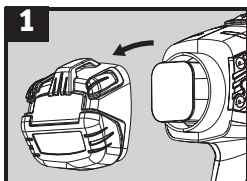

1
UNSCREW BACK CAP.

DESATORNILLE LA TAPA TRASERA.

DÉVISSER LE CAPUCHON ARRIÈRE.

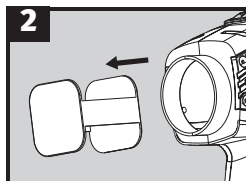

2
REMOVE BATTERY CARTRIDGE.

RETIRE EL CARTUCHO DE LAS PILAS.

RETIRER LA CARTOUCHE DES PILES.

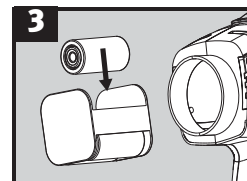

3
INSERT 4 C BATTERIES.
REPLACE CARTRIDGE AND CAP.

COLOQUE 4 PILAS TAMAÑO C. VUELVA A COLOCAR EL CARTUCHO Y LA TAPA.

INSÉRER 4 PILES C. REMETTRE LA CARTOUCHE ET LE CAPUCHON.

Front

THE TOUGHEST FLASHLIGHT YOU'LL EVER NEED™



SOLID CHOICES FOR TOUGH JOBS

Energizer

Energizer Holdings, Inc.
St. Louis, MO 63141

Energizer Canada Inc.
Walkerton, Ontario NOG 2V0

©2007 Energizer
UPN - 123363

Back



CHASEDESIGN

1400 East Genesee Street
Skaneateles, New York 13152
315.685.1000
Fax: 315.685.5021



Process
Black

Attention All Vendors: Please be aware that these files are not necessarily prepared to your pre-press or printing specifications and may need to be modified for trapping, screen rulings, process vs. spot colors, etc.

Please call if you have any questions

Copyright © 2007 ChaseDesign, Inc.

File Name: 024-5229 M01.ai
Date: 01/24/08
Description: 4C Light Instructions
Designer: JMZ
Program/Version: Illustrator CS2

Scale: 100%
Images: Instruction Sheet Back.tif
Fonts: Meta Black, Meta Black LF, Meta Bold LF, Helvetica Neue